



VDI 刀座型錄
VDI Tool holder

固定刀座

Static Tool holder

外徑刀座

Turning Tool holder



VDI	Shank	Specs
VDI25	16	B1-25X16
VDI30	20	B1-30X20
VDI40	25	B1-40X25
VDI50	32	B1-50X32
VDI60	32	B1-60X32

VDI	Shank	Specs
VDI25	16	B3-25X16
VDI30	20	B3-30X20
VDI40	25	B3-40X25
VDI50	32	B3-50X32
VDI60	32	B3-60X32

VDI	Shank	Specs
VDI25	16	B2-25X16
VDI30	20	B2-30X20
VDI40	25	B2-40X25
VDI50	32	B2-50X32
VDI60	32	B2-60X32

VDI	Shank	Specs
VDI25	16	B4-25X16
VDI30	20	B4-30X20
VDI40	25	B4-40X25
VDI50	32	B4-50X32
VDI60	32	B4-60X32

端面 / 外徑刀座

Facing / Turning Tool holder



VDI	Shank	Specs
VDI25	16	C1-25X16
VDI30	20	C1-30X20
VDI40	25	C1-40X25
VDI50	32	C1-50X32
VDI60	32	C1-60X32

VDI	Shank	Specs
VDI25	16	C3-25X16
VDI30	20	C3-30X20
VDI40	25	C3-40X25
VDI50	32	C3-50X32
VDI60	32	C3-60X32

VDI	Shank	Specs
VDI25	16	C2-25X16
VDI30	20	C2-30X20
VDI40	25	C2-40X25
VDI50	32	C2-50X32
VDI60	32	C2-60X32

VDI	Shank	Specs
VDI25	16	C4-25X16
VDI30	20	C4-30X20
VDI40	25	C4-40X25
VDI50	32	C4-50X32
VDI60	32	C4-60X32

內孔刀座

Boring bar Tool holder



VDI	孔徑 Ø(mm)	Specs	
		coolant supply (external)	coolant supply (internal)
VDI25	25	E2-25X25	E1-25X25
VDI30	32	E2-30X32	E1-30X32
VDI40	40	E2-40X40	E1-40X40
VDI50	50	E2-50X50	E1-50X50
VDI60	60	E2-60X50	E1-60X50

VDI	孔徑 Ø(mm)	NH(mm)	Specs coolant supply(internal)
VDI30	32	85	T1-3032-85L
VDI30	32	100	T1-3032-100L
VDI40	40	100	T1-4040-100L
VDI50	50	100	T1-5050-100L

動力刀座

Driven Tool holder

0° 動力刀座
Straight driven Tool holder

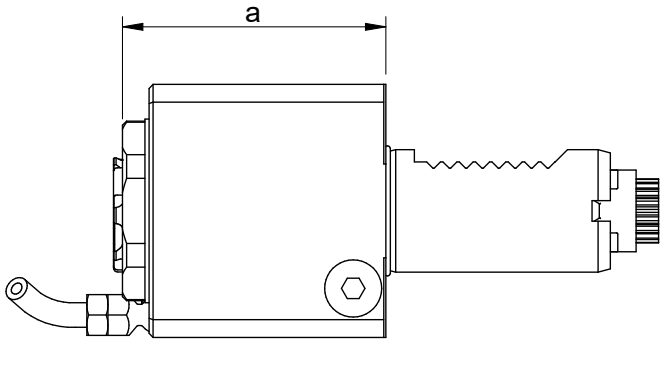

內牙款式 - Internal Nut type

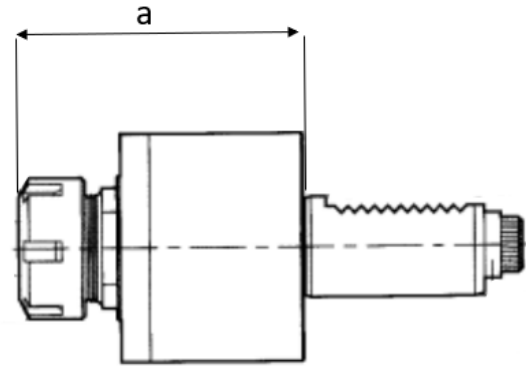
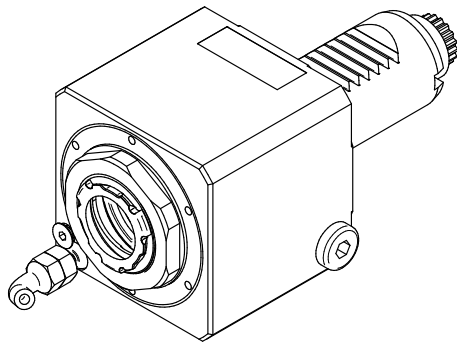

外牙款式 - External Nut type

Type	ER	a NL(mm)	coolant supply	speed (rpm)	gear ratio i=n1:n2	Nut type	Specs
VDI25	20	60	ext. 5~80BAR	8000	1	內牙 int.Nut	VDI25-5480-20
VDI30	25	64.5	ext. 5~80BAR	6000	1	內牙 int.Nut	VDI30-5480-25
	25	101	ext. 5~80BAR	6000	1	外牙 ext.Nut	VDI30-5480-25
VDI40	32	95	ext. 5~80BAR	6000	1	內牙 int.Nut	VDI40-5480-32
	32	109	ext. 5~80BAR	6000	1	外牙 ext.Nut	VDI40-5480-32
VDI50	40	122	ext. 5~80BAR	6000	1	外牙 ext.Nut	VDI50-5480-40
VDI60	50	142	ext. 5~80BAR	6000	1	外牙 ext.Nut	VDI60-5480-50

90° 動力刀座
90° driven Tool holder

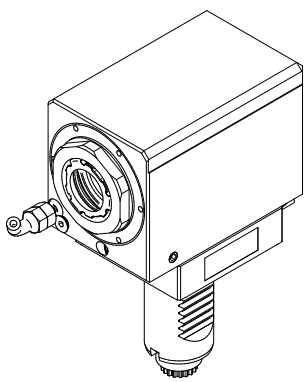

右手-Right

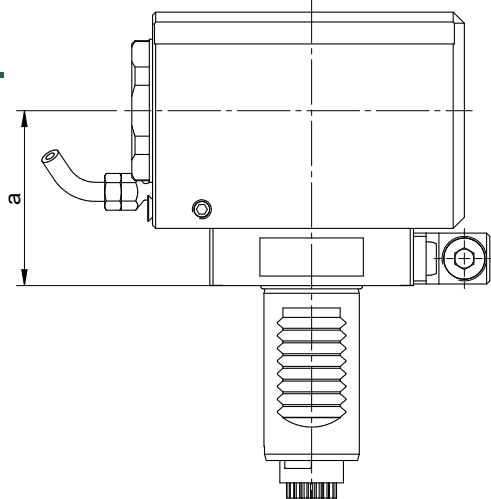

內牙款式 - Internal Nut type

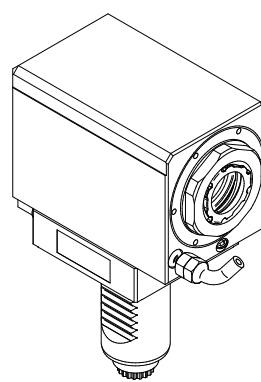

左手-Left

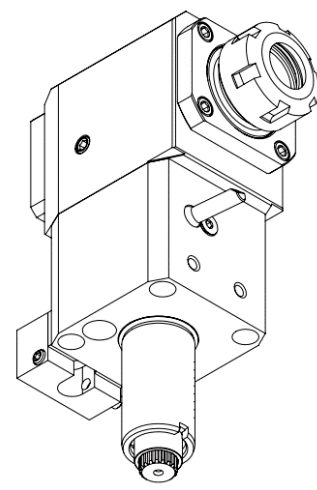

外牙款式 - External Nut type

Type	ER	a NH(mm)	coolant supply	speed (rpm)	gear ratio i=n1:n2	Nut type	Specs
VDI30	25	55	ext. 5~80BAR	7000	1	內牙/外牙 int/ext.Nut	VDI30-5480-25-55-R
		85				外牙 ext.Nut	VDI30-5480-25-85-R
						VDI30-5480-25-85-L	
VDI40	32	100	ext. 5~80BAR	6000	1	內牙/外牙 int/ext.Nut	VD40-5480-32-100-R
						內牙/外牙 int/ext.Nut	VD40-5480-32-100-L
VDI50	40	75	ext. 5~80BAR	5000	1	外牙 ext.Nut	VD40-5480-32-75-R
						外牙 ext.Nut	VD40-5480-32-75-L
VDI60	50	106	ext. 5~80BAR	5000	1	外牙 ext.Nut	VD60-5480-32-106-R
						外牙 ext.Nut	VD60-5480-32-106-L

※ 另有中心出水(選配) ; 請洽營業單位

※ Optional : coolant supply internal GPM | 02

後縮動力刀座

Off-set Driven Tool holder

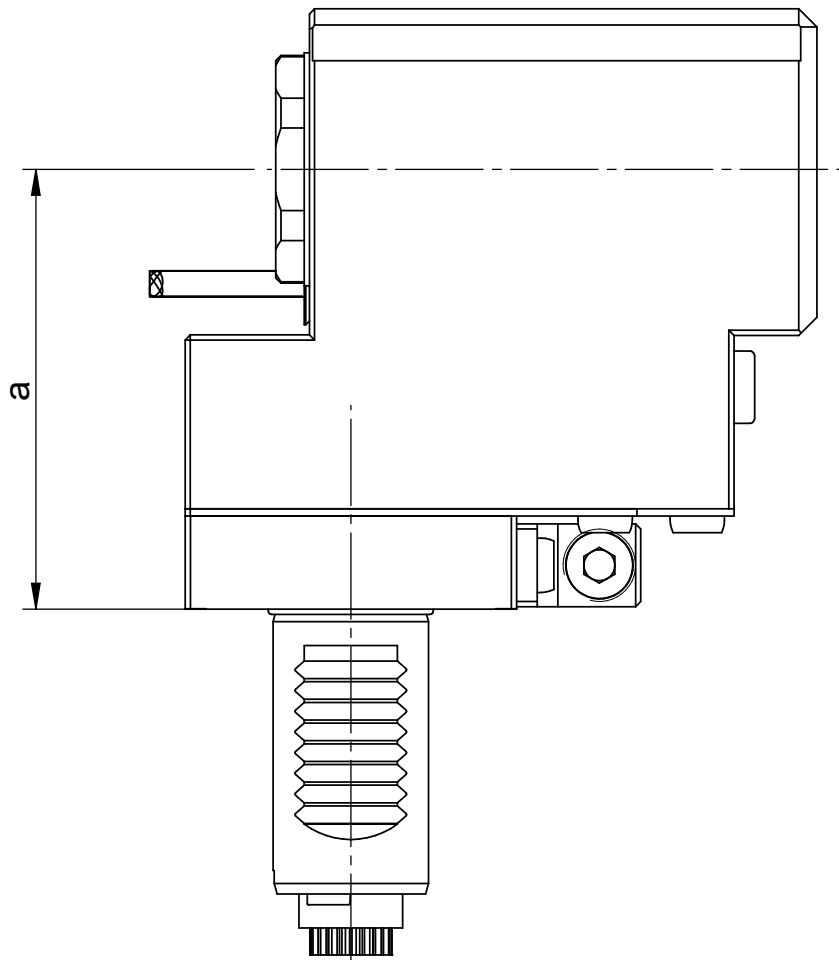

內牙款式 - Internal Nut type

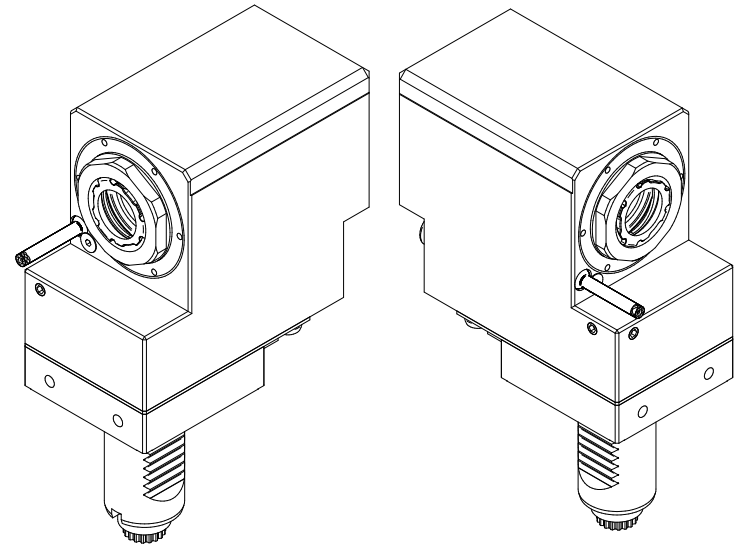

右手-Right

左手-Left

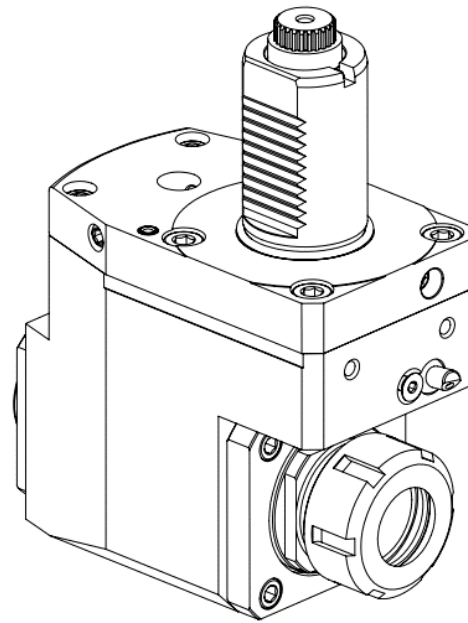

外牙款式 - External Nut type

Type	ER	a NH(mm)	coolant supply	speed (rpm)	gear ratio i=n1:n2	Nut type	Specs
VDI25	20	75	ext. 5~80BAR	8000	1	內牙 int.Nut	VDI25-offset-5480-20-75-R
VDI30	25	85	ext. 5~80BAR	7000	1	內牙/外牙 int/ext.Nut	VDI30-offset-5480-25-85-R
						內牙/外牙 int/ext.Nut	VDI30-offset-5480-25-85-L
VDI40	32	100	ext. 5~80BAR	6000	1	內牙/外牙 int/ext.Nut	VDI40-offset-5480-32-100-R
						內牙/外牙 int/ext.Nut	VDI40-offset-5480-32-100-L
VDI50	40	90	ext. 5~80BAR	5000	1	外牙 ext.Nut	VDI50-offset-5480-32-90-R
						外牙 ext.Nut	VDI50-offset-5480-32-90-L